

REV	DESCRIPTION	MARK
X1	First edition	

SPECIFICATIONS

- Voltage rating: 250V AC,DC
 - Current rating:5A,AC,DC
 - Withstanding Voltage: 1500V AC/minute
 - Insulation resistance:1000M Ω min
 - Temperature range:-25 $^{\circ}$ C - +85 $^{\circ}$ C (including temperature rise in applying electrical current)
 - Contact resistance:30m Ω max
- WAFER**
- Poles:2-16
 - Material:Nylon 66, UL94V-0
 - Brass Tin-plating
 - QTY:1000 pcs/bag

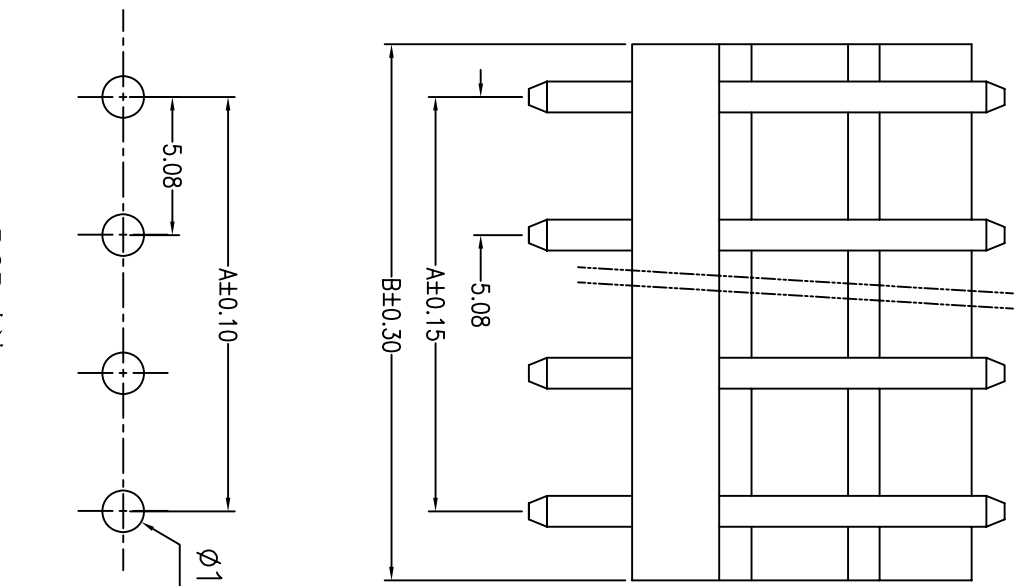

PCB 寸法
PCB LAYOUT

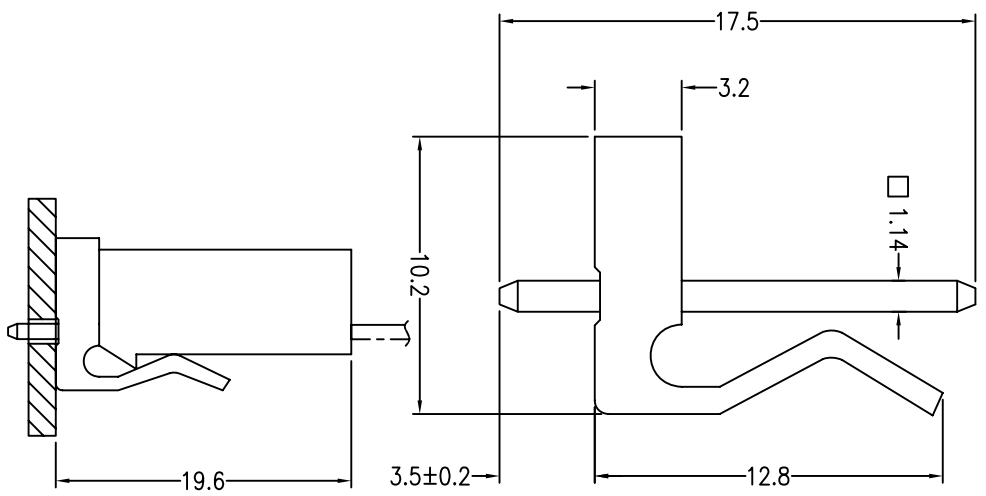

安装尺寸
MOUNTING MEASUREMENT

Poles	A	B
2A	5.08	9.08
3A	10.16	14.16
4A	15.24	19.24
5A	20.32	24.32
6A	25.40	29.40
7A	30.48	34.48
8A	35.56	39.56
9A	40.64	44.64
10A	45.72	49.72

CCCDX 深圳市诚得信电子有限公司
SHENZHEN CHENGDEXIN ELECTRONICS CO.,LTD

X. ±	X. ±	MAT'L	USE:	PART NO.:	TITLE:
.X ± 0.25	.X ±	—	—		5.08-nA
.XX ± 0.15	.XX ±	FINISH	APPD:	DWG. NO.:	
.XXX ± 0.05	.XXX ±	—	CHKD:		
UNITTS: mm	Q'TY	DR:	邓琴	SCALE 1:1	SHEET 1/1
					REV. X1